

Variante I

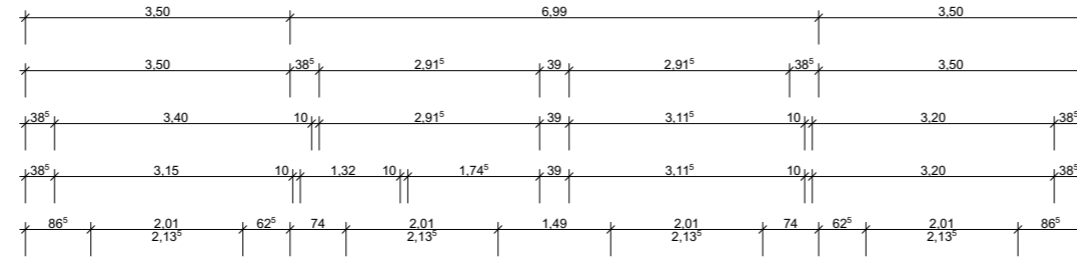

Variante II

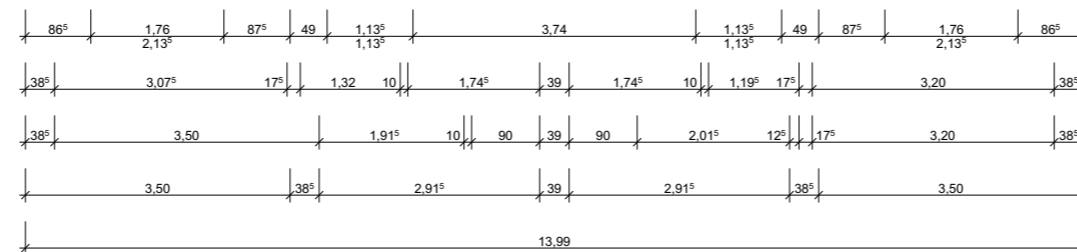
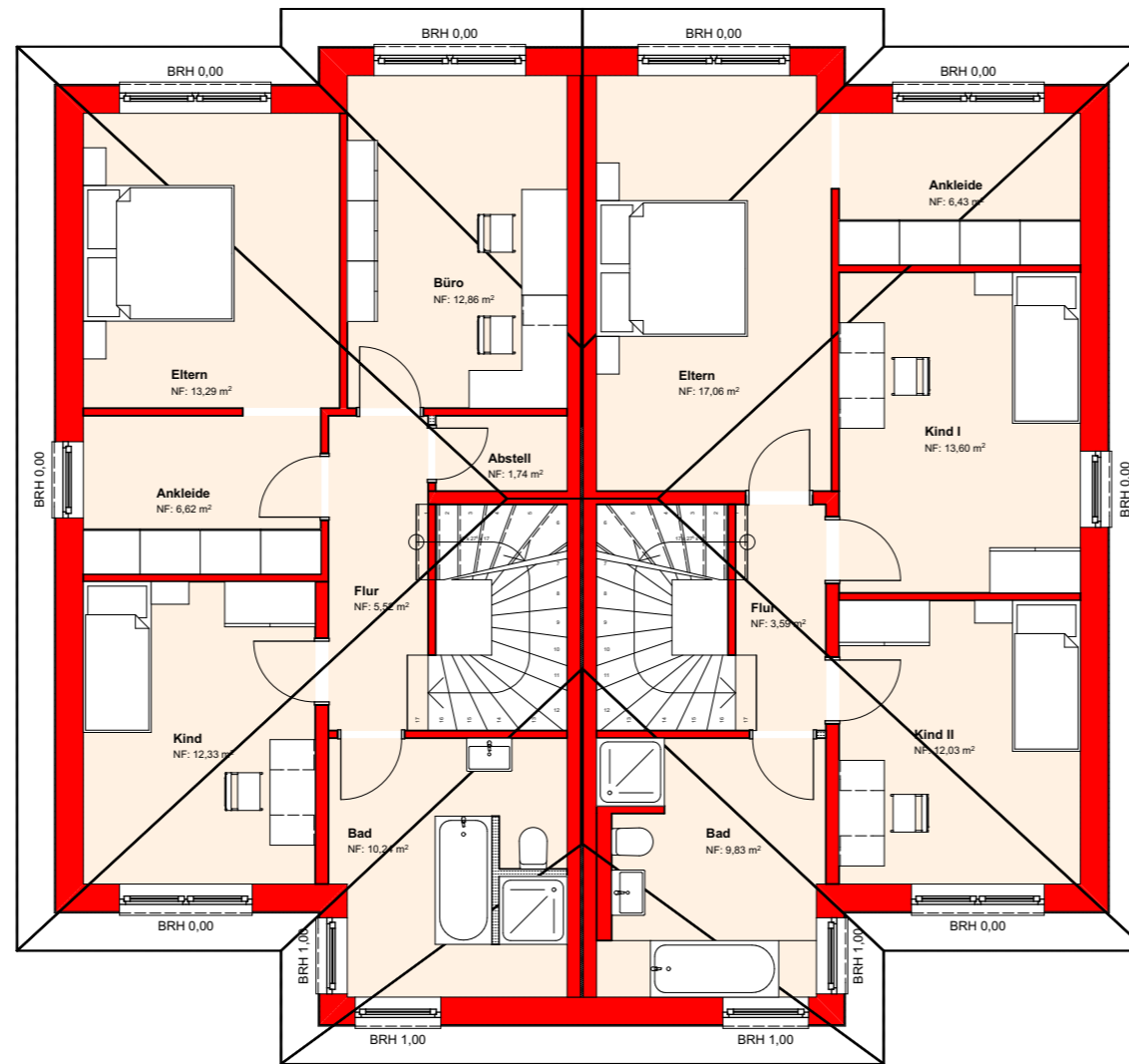
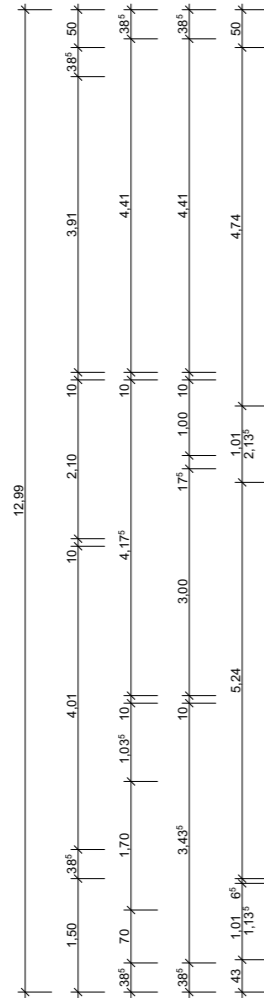
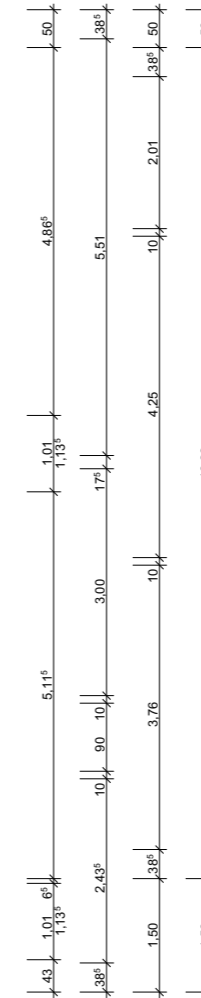

# Obergeschoss

**BAUVORHABEN:**

Neubau einer Doppelhaushälfte  
Rhönstraße 14  
63110 Rodgau (OT Rollwald)

**AUFTRAGGEBER:**

B A C H Projektentwicklung GmbH  
Eisenbahnstr. 11  
63310 Rodgau-Jügesheim

**PLANUNG:**

Hettwer Plan GmbH  
Arch.-Nr. EL. 11.087  
Ing.-Nr. 36660  
Am Brunning 12  
49577 Anikum  
Tel.: 05462 / 7404-0

**Datum:**

18.5.021

**Plan:**

OG  
2.0.1

**gez.:**  
ML

Unterschrift Bauherr

Unterschrift Entwurfsverfasser